

## BK2020

Drawn cup needle roller bearing closed end

Schaeffler Kimliği:  
0001770670000

Drawn cup needle roller bearings with  
closed end BK, to DIN 618/ISO 3245

### Teknik bilgiler

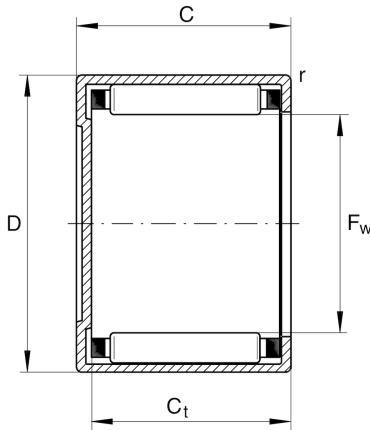

#### Dimensions

$r_{min}$	0,8 mm	Minimum chamfer dimension
$C_{t min}$	17,3 mm	Minimum width to base of drawn cup with closed end
	26,412 g	Ağırlık

#### Main Dimensions & Performance Data

$F_w$	20 mm	Under roller diameter
$D$	26 mm	Outside diameter
$C$	20 mm	Width, outer ring
$C_r$	15.700 N	Basic dynamic load rating, radial
$C_{0r}$	26.000 N	Basic static load rating, radial
$C_{ur}$	3.600 N	Fatigue load limit, radial
$n_G$	12.700 1/min	Limiting speed
$n_{G Grease}$	7.600 1/min	Limiting speed for grease lubrication
$n_{\vartheta r}$	9.300 1/min	Reference speed

#### Additional information

SD20X26X4	Sealing ring
G20X26X4	Sealing ring 2
LR17X20X20,5	Suitable inner rings LR
IR17X20X20-XL	Suitable inner rings IR

#### Temperature range

$T_{min}$	-30 °C	Operating temperature min.
$T_{max}$	140 °C	Operating temperature max.