



## CSXA075

### Four-point contact bearing

Schaeffler Kimliği:  
0050008660000

Four point contact bearing, Thin section  
bearing CSXA, brass sheet metal cage

### Teknik bilgiler

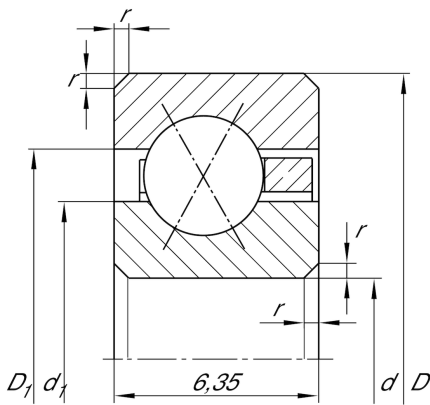

### Dimensions

$r_{min}$	0,6 mm	Minimum chamfer dimension
$d_1$	195,2 mm	Shoulder diameter inner ring
$D_1$	198,5 mm	Shoulder diameter outer ring
$\alpha$	30 °	Contact angle
	150 g	Ağırlık

### Main Dimensions & Performance Data

$d$	190,5 mm	Bore diameter
$d$	7.5 inch	Bore diameter (Inch)
$D$	203,2 mm	Outside diameter
$B$	6,35 mm	Width
$C_r$	7.000 N	Basic dynamic load rating, radial
$C_{0r}$	16.700 N	Basic static load rating, radial
$n_G$	1.110 1/min	Limiting speed for grease lubrication
$n_G$	1.590 1/min	Limiting speed for oil lubrication

### Temperature range

$T_{min}$	-30 °C	Operating temperature min.
$T_{max}$	120 °C	Operating temperature max.