

HN4520

Drawn cup needle roller bearing open end

Schaeffler Kimliği:
0000369510000

Drawn cup needle roller bearings with open ends HN, full complement needle roller set

Teknik bilgiler

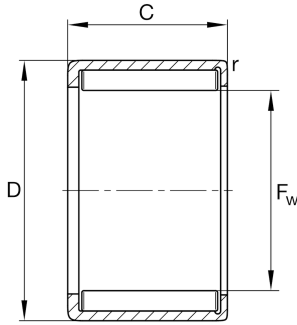

Dimensions

r_{min}	0,8 mm	Minimum chamfer dimension
	68 g	Ağırlık

Main Dimensions & Performance Data

F_w	45 mm	Under roller diameter
D	52 mm	Outside diameter
C	20 mm	Width, outer ring
C_r	38.500 N	Basic dynamic load rating, radial
C_{0r}	108.000 N	Basic static load rating, radial
C_{ur}	14.700 N	Fatigue load limit, radial
$n_{G Grease}$	2.500 1/min	Limiting speed for grease lubrication
n_{gr}	3.400 1/min	Reference speed

Additional information

IR40X45X20-XL	Suitable inner rings IR
LR40X45X20,5	Suitable inner rings LR

Temperature range

T_{min}	-30 °C	Operating temperature min.
T_{max}	140 °C	Operating temperature max.